

wound. Press the STOP button and remove the cassette.

7. When the cassette is completely rewound, the unit will stop and the "Start" button will pop out.
8. To remove the cassette, lift the lid.

You can stop the process at any time by pushing the "STOP" button.

**WARNING:**

To avoid possible damage to a 6mm DV tape, do not attempt to operate, insert or remove tape without batteries installed or AC adapter plugged in.

**90 DAY LIMITED WARRANTY**

Sima Products Corporation warrants this product against defects in materials and workmanship for a period of 90 days from the date of purchase. During the warranty period, the product will be repaired or replaced, at Sima's discretion. Mail the enclosed product registration card within ten days of original purchase.

**CONDITIONS**

1. Ship your unit, freight prepaid, including reasonable proof of date and place of purchase and description of problem to: Sima Products, 140 Pennsylvania Ave., Bldg. #5, Oakmont, PA 15139. (412) 828-3700.

2. This warranty is void if any defects are caused by abuse, misuse, negligence or unauthorized repairs.

3. All liability for incidental or consequential damages is specifically excluded. Some states

do not allow the exclusion or limitation of incidental or consequential damages, so the above limitation or exclusion may not apply to you. This warranty gives you specific legal rights, and you may also have other rights which vary from state to state.



Sima Products Corporation  
140 Pennsylvania Avenue Bldg.  
#5

Oakmont, PA 15139 USA  
800.345.7462

[www.simacorp.com](http://www.simacorp.com)

© 2001 Sima Products Corp.

P/N 21635  
01.4



---

**Model SRW-62**

**Portable AC/DC  
Two-Way Rewinder  
for 6mm DV Tapes**

## 6mm Two-Way Rewinder Instructions - Model SRW-62

The Sima 6mm Two-Way Rewinder is a quality product that will save wear and tear on your 6mm DV camcorder. It is portable, quiet and light-weight and can be used anywhere to rewind or fast-forward your 6mm tapes. It can be used with batteries or an optional AC adapter.

The Sima Rewinder will rewind your 6mm DV (60 min) tape in approximately 2 minutes.

### **WARNING:**

Do not attempt to open the lid if the start button is pressed or the unit is winding. To avoid possible damage to a 6mm DV tape, do not attempt to

operate, insert or remove tape without batteries installed or AC adapter plugged in.

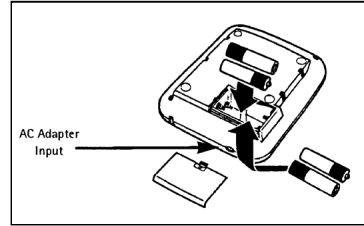
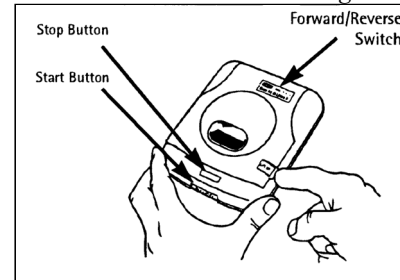

Figure 1

1. To install batteries refer to Figure 1. Slide open the battery compartment door and install 4 AAA batteries (not included) as shown above. Be sure to observe the correct polarity.
2. The Sima 6mm Rewinder can also be used indoors with an

optional AC adapter. Use only the proper adapter (Contact Sima) to prevent damage to the rewinder and your 6mm DV tape. Plug the adapter into any household electrical outlet and the plug into the DC input jack on the back of the unit. The batteries can remain in the unit while using the AC adapter.

Figure 2



3. Open the lid by holding the bottom of the unit and lifting up on the side. (Refer to Figure 2)
4. Insert the 6mm DV cassette TAPE SIDE FIRST, and close the lid by pressing down. Do not force the lid closed. If it will not close completely, check if the cassette has been inserted correctly.
5. Select the desired direction with the FF/REW switch (Refer to Figure 2)
6. Depress the "START" button. The unit will begin to operate. If the unit does not start or makes a strange sound, the tape is already  
Continued....